



Claredale Street, London, E2

BUTLER  STAG



Guide Price £600,000 - £650,000
This duplex two bedroom apartment within Keeling House offers a unique living space with a blend of historical significance and modern amenities. Keeling House is a distinctive Grade II listed apartment building located in Bethnal Green. Originally designed by architect Denys Lasdun, Keeling House is renowned for its innovative design and was one of the first examples of Brutalist architecture in the United Kingdom.



Leasehold

- 780 Sq/Ft Living Space
- Designed by Architect Denys Lasdun
- 974 Year Lease
- Secure Parking Space
- Duplex First Floor Apartment
- Private Balcony
- Concierge Service
- Bethnal Green Tube Station Close By Providing Easy Access To The City

This split level apartment creates distinct zones within the property, offering residents a sense of separation and privacy between living areas. The main living area features a well-designed layout, maximizing space and functionality providing a place to relax and entertain guests. The contemporary kitchen design is equipped with all the essential appliances and has ample cupboard space and also a breakfast bar.

There are two bedrooms each offering great proportions with enough space for a bed, wardrobe, and additional furnishings. The well-appointed bathroom has modern fixtures, including a bathtub or shower, sink, and toilet.

Keeling House offers a secure environment with secure entry system and an on-site concierge.

Keeling House's location in Bethnal Green offers residents easy access to a range of amenities, including shops, restaurants, parks, and public transportation options. Bethnal Green is known for its vibrant atmosphere, cultural diversity, and proximity to trendy areas like Shoreditch and Hackney.



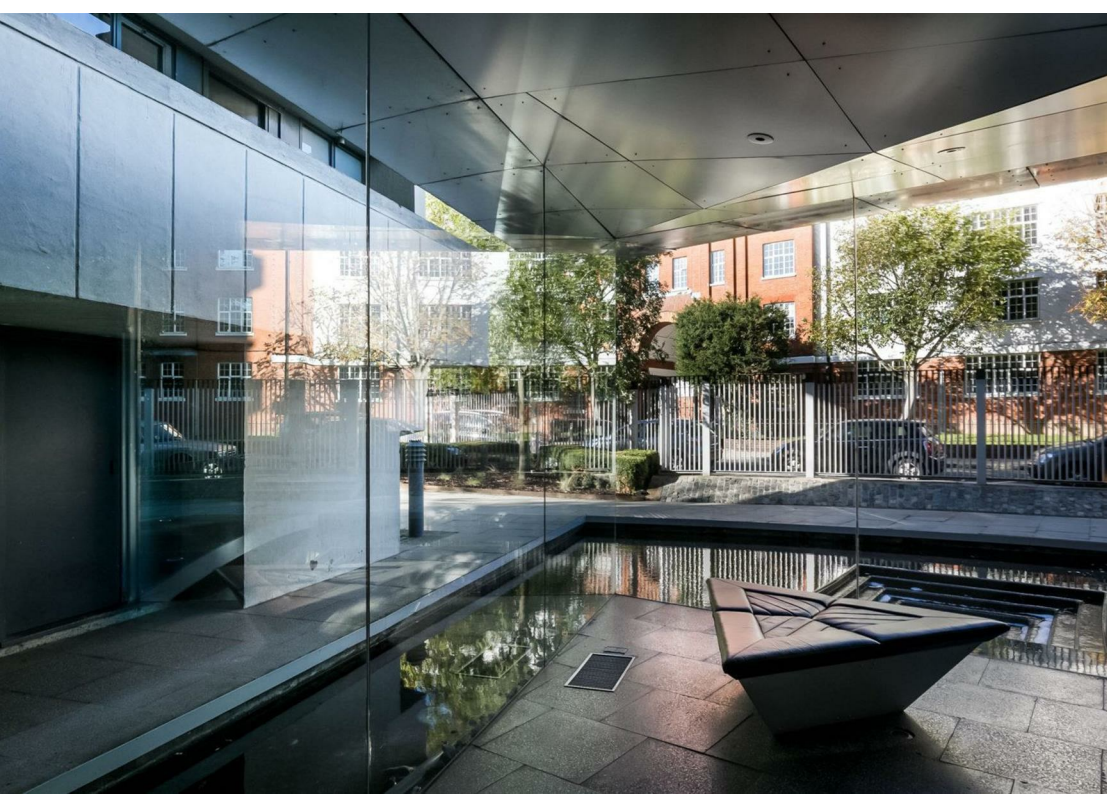

Keeling House

Approx. Gross Internal Area 72.5 Sq M (780.2 Sq Ft)

BUTLER & STAG



Measurements are approximate and for illustration purposes only. While we do not doubt the accuracy and completeness, we advise you conduct a careful independent assessment of the property to determine monetary value.
© @modephoto.uk www.modephoto.co.uk

IMPORTANT NOTICE - These particulars have been prepared in good faith and they are not intended to constitute part of an offer or contract. We have not performed a structural survey on this property and the services, appliances and specific fittings have not been tested. All photographs, measurements, floor plans and distances referred to are given as a guide and should not be relied upon.

BUTLER & STAG

☎ 020 8102 1236

🏠 508 Roman Road, Bow, London, E3 5LU

✉ bow@butlerandstag.com

www.butlerandstag.uk